

HIGHWAY LANDSCAPE DEVELOPMENT PROJECT

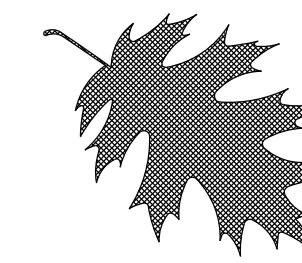

| | | | |
|--------------|------------------------|---------|---------------|
| T.I.P. # | STATE PROJECT W.B.S. # | SHEET # | SHEET # TOTAL |
| U-3338 B | | L 1 | 10 |
| FED. PROJ. # | DESCRIPTION | | DIVISION |
| - | LANDSCAPE | | 3 |

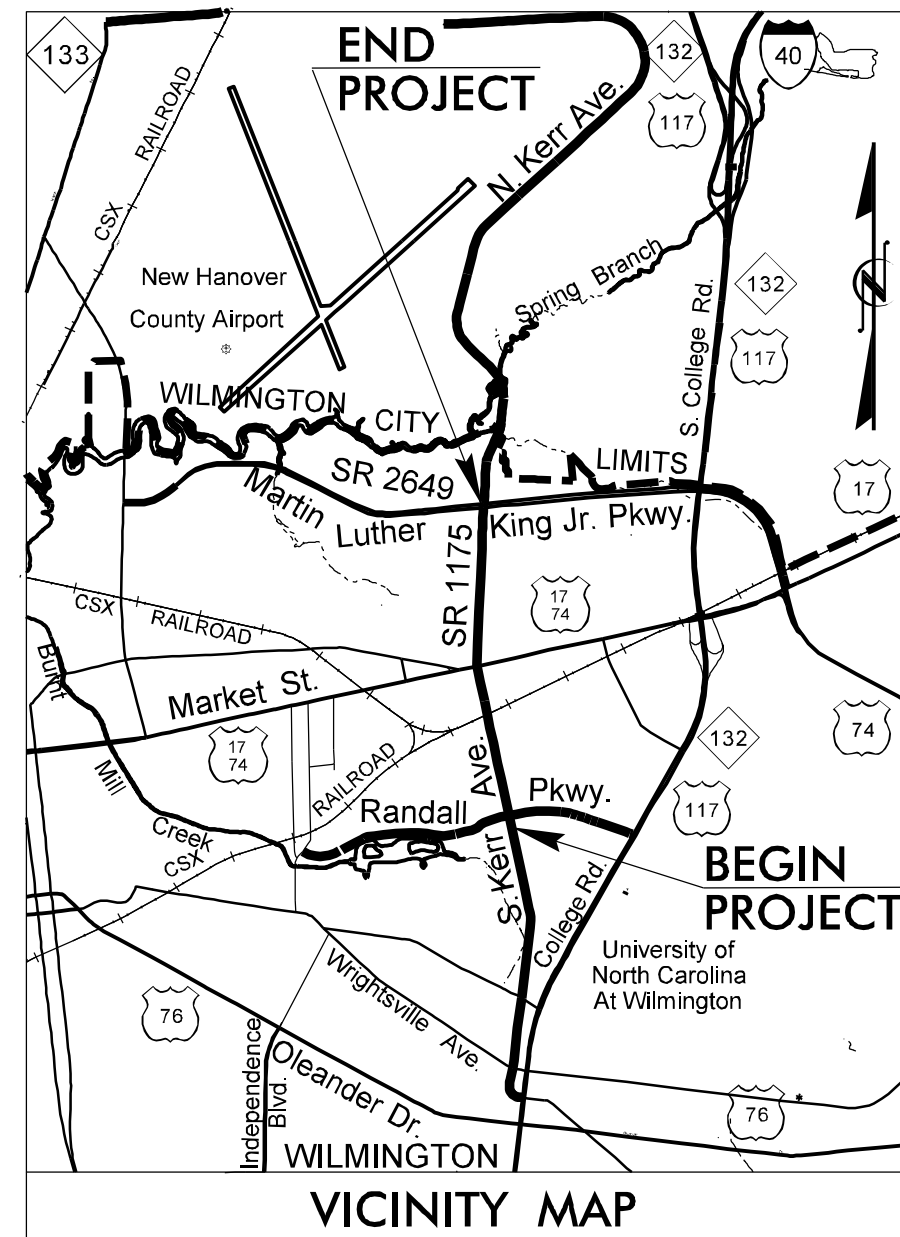

NEW HANOVER COUNTY LANDSCAPE ENHANCEMENT

LOCATION: KERR AVE, WILMINGTON NC
TYPE OF WORK: LANDSCAPE DEVELOPMENT

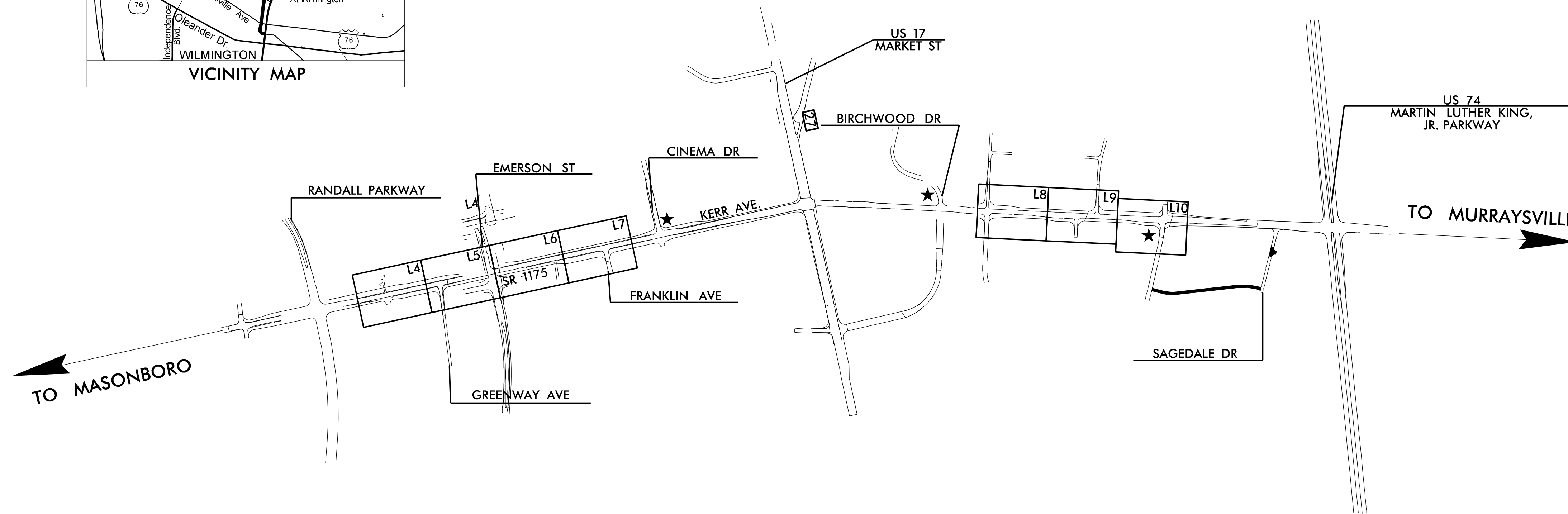

CONVENTIONAL SYMBOLS

| | |
|---------------------------------|-------------|
| County Line | ----- |
| City or Town Line | ----- |
| Exist. Right of Way Line Marker | -----▲----- |
| Prop. Right of Way Line Marker | -----▲----- |
| (By Others) | -----▲----- |
| Prop Right of Way Line Marker | -----▲----- |
| (By Contract) | -----▲----- |
| Exist. Control of Access Line | -----○----- |
| Prop. Control of Access Line | -----○----- |
| Property Line | -----○----- |
| Easement Line | -----○----- |
| Slope Stake Line | -----○----- |
| Exist. Fence | -----○----- |
| Prop. Woven Wire Fence | -----○----- |
| Prop. Chain Link Fence | -----○----- |
| Exist. Road | ===== |
| Prop. Road | ===== |
| Guardrail | -----○----- |
| Survey Line | -----○----- |
| Denotes Line Equality | -----○----- |
| Bridge | -----○----- |
| Culvert | -----○----- |
| Railroad | -----○----- |
| Woods | -----○----- |
| Exist. Telephone Pole | -----○----- |
| Prop. Telephone Pole | -----○----- |
| Tower Pole and Line | -----○----- |
| Exist. Power Pole | -----○----- |
| Prop. Power Pole | -----○----- |
| Sanitary Sewer Line | -----○----- |
| Water Line | -----○----- |
| Gas Line | -----○----- |
| Picnic Shelter | -----○----- |
| Regeneration | -----○----- |
| Reforestation | -----○----- |

INDEX OF L SHEETS:

| | |
|----------|----------------------------------|
| L1 | TITLE, DESCRIPTION, LOCATION |
| L2 | PLANTING DETAILS & NOTES |
| L3 | PLANTING BED DETAIL & QUANTITIES |
| L4 - L10 | LANDSCAPE PLANS |

PREPARED BY: BK DATE: 4/2021

REVISIONS

| DATE | DESCRIPTION |
|----------|---------------------------------|
| 11-6-19 | REV IRR. PGS., LINE ITEMS, ETC. |
| 10-22-19 | ELIMINATE IRRIGATION |
| 4-27-21 | REDESIGN- WITH NATIVES |

PROJECT: KERR AVE., WILMINGTON, NC

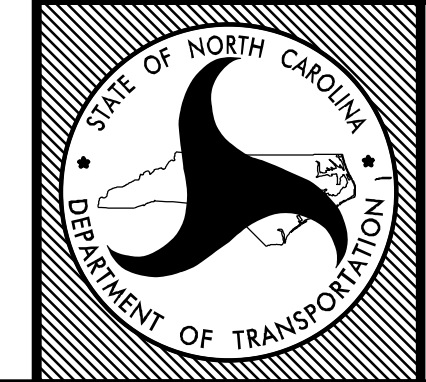

STATE OF
NORTH CAROLINA
DEPARTMENT OF TRANSPORTATION

| | |
|---------------|-------------------------|
| LOCATION: | KERR AVE, WILMINGTON NC |
| TYPE OF WORK: | LANDSCAPE DEVELOPMENT |
| COUNTY: | NEW HANOVER COUNTY |

2014 American Standard for Nursery Stock
 2018 NCDOT STANDARD SPECIFICATIONS
 PREPARED IN THE OFFICE OF:
 NCDOT- ROADSIDE ENVIRONMENTAL UNIT
 LANDSCAPE DESIGN & DEVELOPMENT SECTION
 1557 MAIL SERVICE CENTER
 RALEIGH NC 27699 919-707-2920

\$\$\$\$\$SYTIME\$\$\$\$\$
\$\$\$\$\$USERNAME\$\$\$\$\$

IN ARID, DRY, OR SANDY SOIL LOCATIONS, PLANT THE TREE BALL LEVEL WITH THE SURROUNDING GRADE. IN LOW LAYING OR WET AREAS, PLANT THE TREE BALL SLIGHTLY HIGHER.

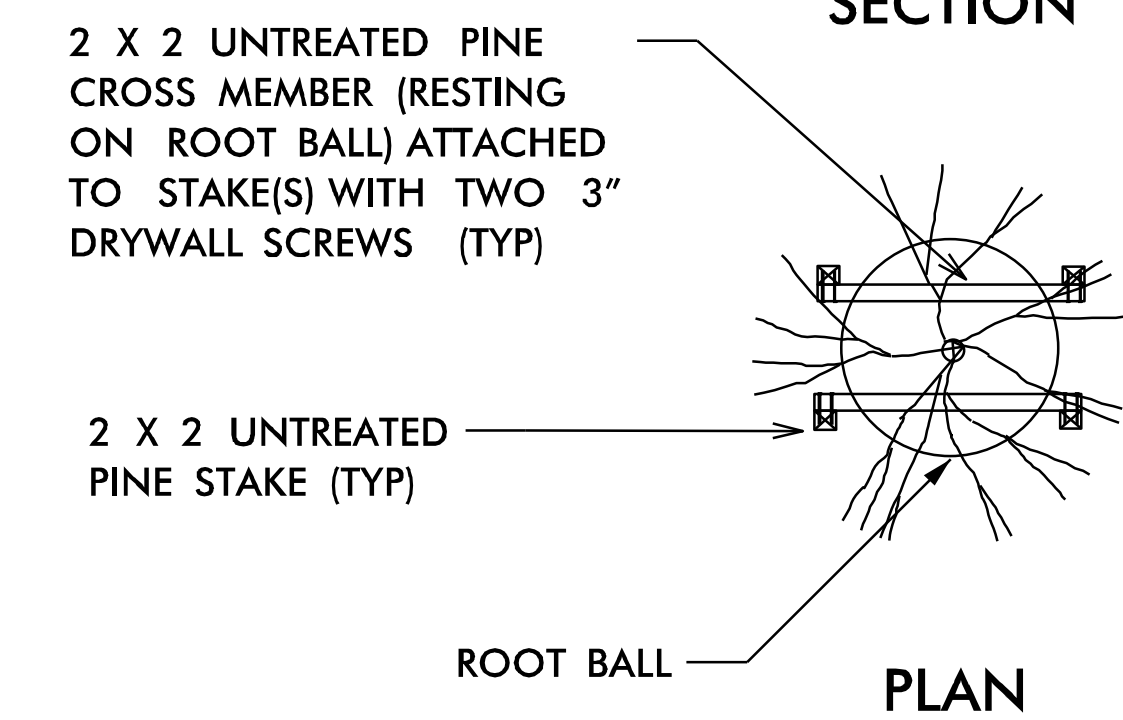
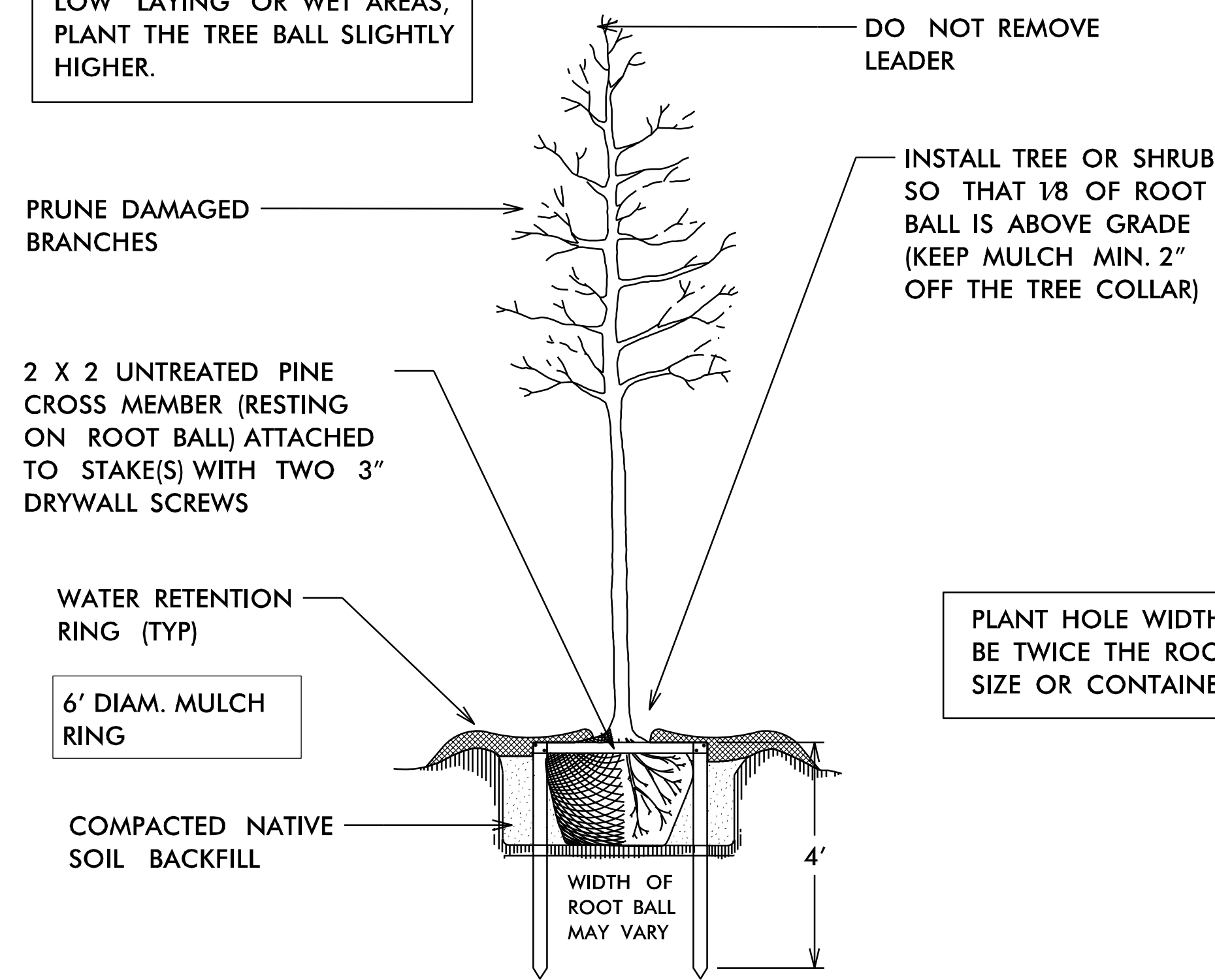

TREE PLANTING & ROOT BALL STAKING DETAIL
(STAKE TREES 8' OR TALLER)

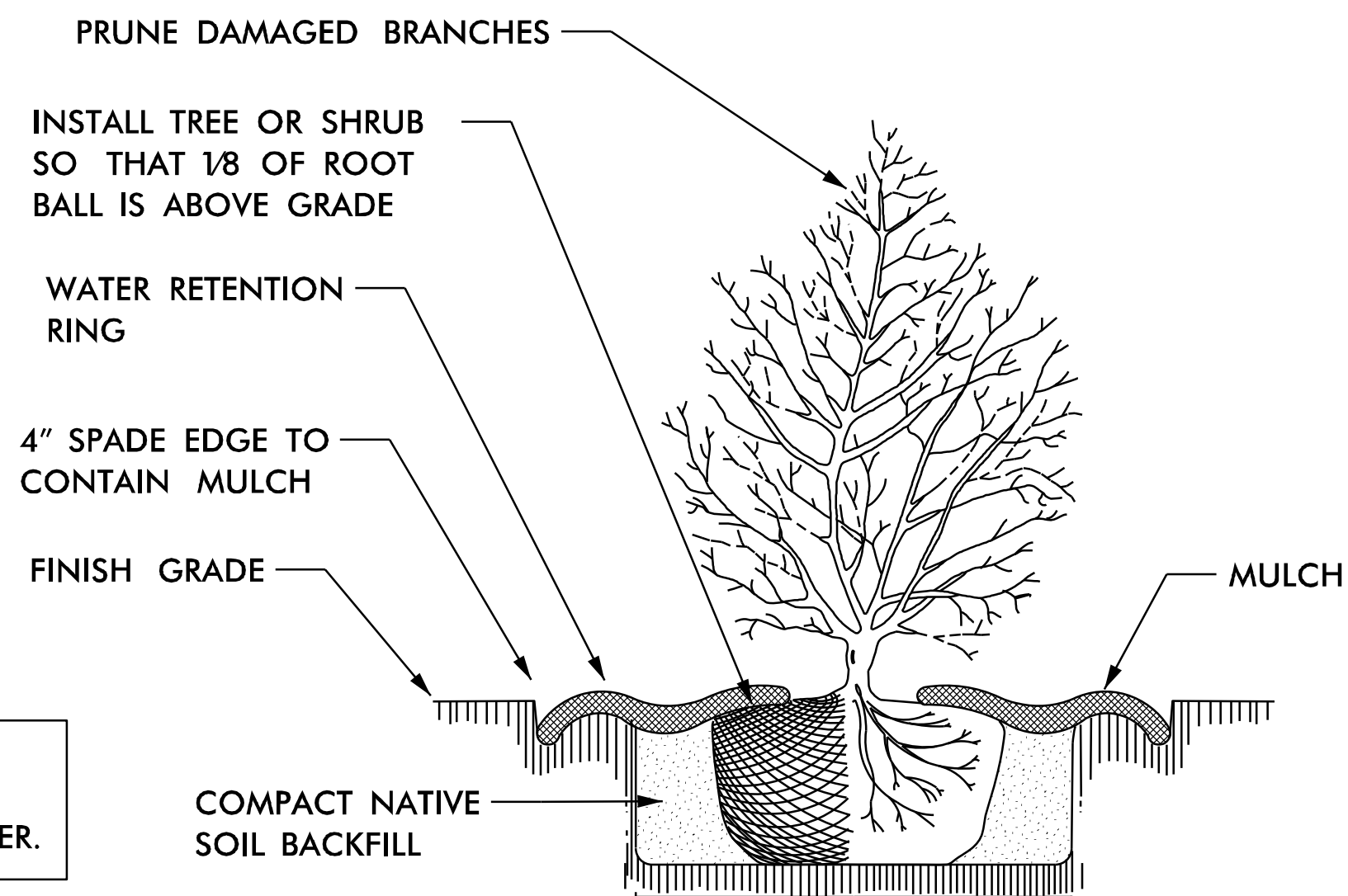

TREE OR SHRUB PLANTING DETAIL

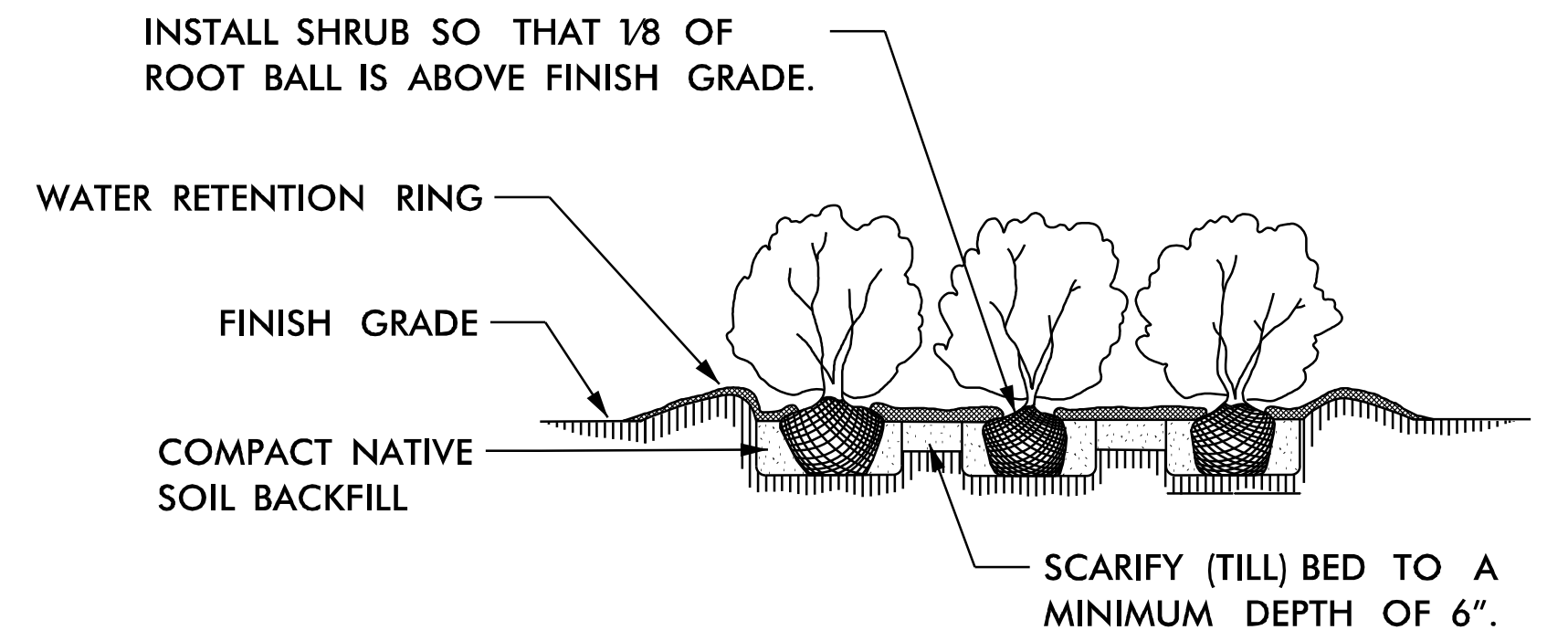

SHRUB BED PLANTING DETAIL

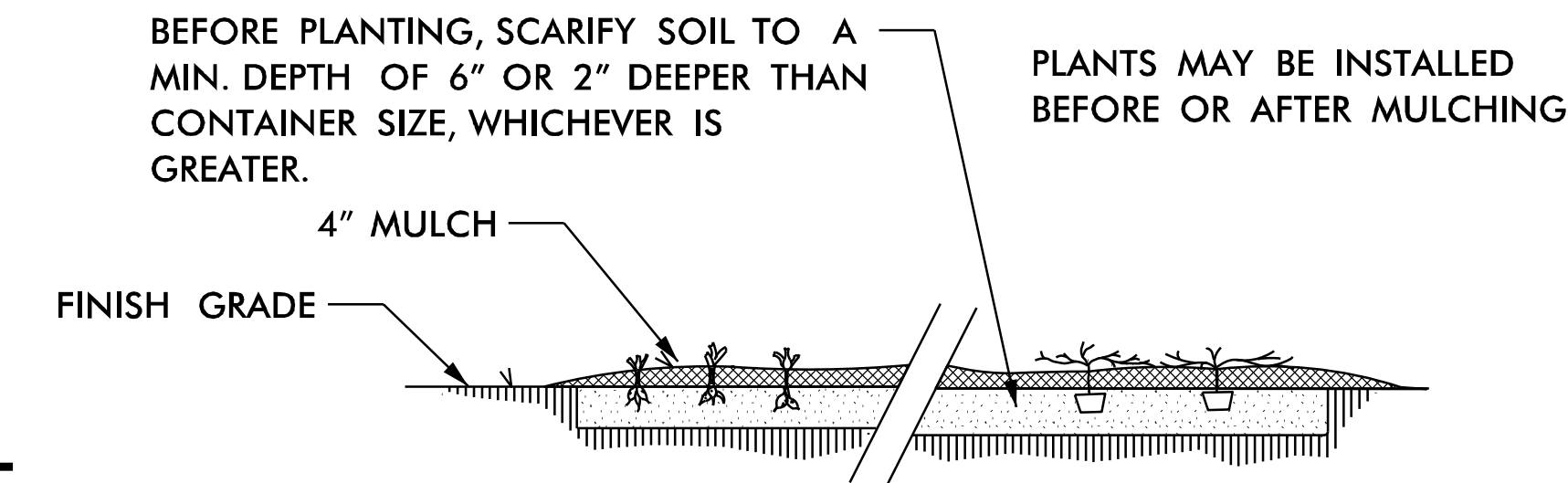

GROUND COVER/BEDDING PLANT DETAIL

GENERAL LANDSCAPE NOTES

1. ALL PLANTS MUST BE HEALTHY, VIGOROUS MATERIAL, FREE OF PESTS AND DISEASE.
2. ALL PLANTS MUST BE CONTAINER GROWN OR BALLED AND BURLAPPED AS INDICATED IN THE PLANT LIST.
3. ALL TREES MUST HAVE A STRAIGHT TRUNK AND FULL HEADED AND MEET ALL REQUIREMENTS SPECIFIED.
4. ALL PLANTS ARE SUBJECT TO THE APPROVAL OF THE ROADSIDE ENGINEER/LANDSCAPE ARCHITECT BEFORE.
5. ALL TREES MUST BE GUYED OR STAKED AS SHOWN IN THE DETAILS.
6. ALL PLANTING AREAS MUST BE COMPLETELY MULCHED AS SPECIFIED. MULCH TO BE FOUR (4) INCHES OF DOUBLE SHREDDED HARDWOOD MULCH.
7. PRIOR TO CONSTRUCTION, THE CONTRACTOR SHALL BE RESPONSIBLE FOR LOCATING ALL UNDERGROUND UTILITIES AND SHALL AVOID DAMAGE TO ALL UTILITIES DURING THE COURSE OF THE WORK. THE CONTRACTOR IS RESPONSIBLE FOR REPAIRING ANY AND ALL DAMAGE TO UTILITIES, STRUCTURES, SITE APPURTENANCES, ETC. WHICH OCCURS AS A RESULT OF THE LANDSCAPE CONSTRUCTION. CONTRACTOR IS ALSO RESPONSIBLE FOR COORDINATING ALL UTILITY ADJUSTMENTS WITH FINAL FINISH GRADE. ALL UTILITIES SHALL SIT FLUSH WITH FINISH GRADES (BOTH PAVED AND LANDSCAPED SURFACES).
8. THE CONTRACTOR IS RESPONSIBLE FOR VERIFYING ALL QUANTITIES SHOWN ON THESE PLANS BEFORE PRICING THE WORK. ANY DISCREPANCIES BETWEEN QUANTITIES ON PLAN AND PLANT LIST SHALL BE BROUGHT TO THE ATTENTION OF NCDOT INSPECTOR AND ANY FIELD ADJUSTMENTS OR QUANTITY ADJUSTMENTS MUST BE AUTHORIZED PRIOR TO PLANTING.
9. THE CONTRACTOR IS RESPONSIBLE FOR FULLY MAINTAINING ALL PLANTING (INCLUDING BUT NOT LIMITED TO: WATERING, SPRAYING, MULCHING, WEEDING, FERTILIZING, ETC.) OF THE PLANTING AREAS AND LAWN UNTIL SUBSTANTIAL COMPLETION.
10. THE CONTRACTOR SHALL COMPLETELY WARRANTEE ALL PLANT MATERIAL FOR A PERIOD OF ONE (1) YEAR BEGINNING ON THE DATE OF SUBSTANTIAL COMPLETION. THE CONTRACTOR SHALL PROMPTLY MAKE ALL REPLACEMENTS BEFORE OR AT THE END OF THE WARRANTEE PERIOD.
11. THE ROADSIDE ENGINEER/LANDSCAPE ARCHITECT SHALL APPROVE THE STAKING LOCATION OF ALL PLANT MATERIAL PRIOR TO INSTALLATION. CONTRACTOR SHALL CONTACT THE PROJECT LANDSCAPE ARCHITECT A MINIMUM OF ONE(1) WEEK IN ADVANCE TO SCHEDULE STAKING.
12. ANY PLANT MATERIAL WHICH DIES, TURNS BROWN, OR DEFOLIATES (PRIOR TO SUBSTANTIAL COMPLETION OF THE WORK) SHALL BE PROMPTLY REMOVED FROM THE SITE AND REPLACED WITH MATERIAL OF THE SAME SPECIES, QUANTITY, AND SIZE MEETING ALL PLANT SCHEDULE SPECIFICATIONS.
13. STANDARDS SET FORTH IN "AMERICAN STANDARD FOR NURSERY STOCK" REPRESENT GUIDELINE SPECIFICATIONS ONLY AND SHALL CONSTITUTE MINIMUM QUALITY REQUIREMENTS FOR PLANT MATERIAL.
14. ALL SHRUB, GROUND COVER AND PERENNIAL PLANTING BEDS ARE TO BE COMPLETELY COVERED WITH DOUBLE SHREDDED HARDWOOD MULCH TO A DEPTH OF FOUR (4) INCHES. ANY EXISTING LANDSCAPE BEDS THAT ARE DISTURBED MUST BE MULCHED TO MATCH EXISTING MULCH FOUND
15. LOCATIONS OF EXISTING BURIED UTILITY LINES SHOWN ON THE PLANS ARE BASED UPON BEST AVAILABLE INFORMATION AND ARE TO BE CONSIDERED APPROXIMATE. IT SHALL BE THE RESPONSIBILITY OF THE CONTRACTOR TO VERIFY THE LOCATIONS OF UTILITY LINES AND ADJACENT TO THE WORK AREA. THE CONTRACTOR IS RESPONSIBLE FOR THE PROTECTION OF ALL UTILITY LINES DURING THE CONSTRUCTION PERIOD.
16. SAFE, CLEARLY MARKED PEDESTRIAN AND VEHICULAR ACCESS TO ALL ADJACENT PROPERTIES MUST BE MAINTAINED THROUGHOUT THE CONSTRUCTION PROCESS.
17. ALL PLANT MATERIAL QUANTITIES SHOWN ARE APPROXIMATE. CONTRACTOR SHALL BE RESPONSIBLE FOR COMPLETE COVERAGE OF ALL PLANTING BEDS AT SPACING SHOWN.
18. THE TOP OF ALL ROOT BALLS SHALL BEAR THE SAME RELATIONSHIP TO FINISHED GRADE, AS BORN TO PREVIOUS GRADE AND GROWING CONDITIONS.
19. ALL ROOT BALLS REMOVED FROM CONTAINERS SHALL BE SCARIFIED PRIOR TO BACKFILLING.
20. CONTRACTOR SHALL COMPLY WITH ALL APPLICABLE CODES & ORDINANCES REGARDING LANDSCAPING. GENERAL CONTRACTOR IS TO CLEAN THE ENTIRE SITE OF ALL CONSTRUCTION DEBRIS PRIOR TO FINAL INSPECTION.
21. CONTRACTOR SHALL IDENTIFY STAGING AREAS, APPROVED BY THE ROADSIDE ENGINEER, PRIOR TO CONSTRUCTION.
22. USE OF HERBICIDES, PESTICIDES, AND FERTILIZERS SHALL BE USED IN ACCORDANCE WITH ALL LOCAL, STATE, AND FEDERAL GUIDELINES.

North Carolina Department of Transportation
Roadside Environmental Unit
Aesthetic Engineering Section



PROJECT TITLE :
KERR AVE, WILMINGTON NC
WILMINGTON NC
NEW HANOVER CO

| | |
|-------------------|------------------|
| Plans Drawn By: | BK |
| Scale | |
| Date | 9 / 13 / 2019 |
| Sheet Description | Planting Details |
| T.I.P. # | U-3338 B |
| Sheet # | L2 |

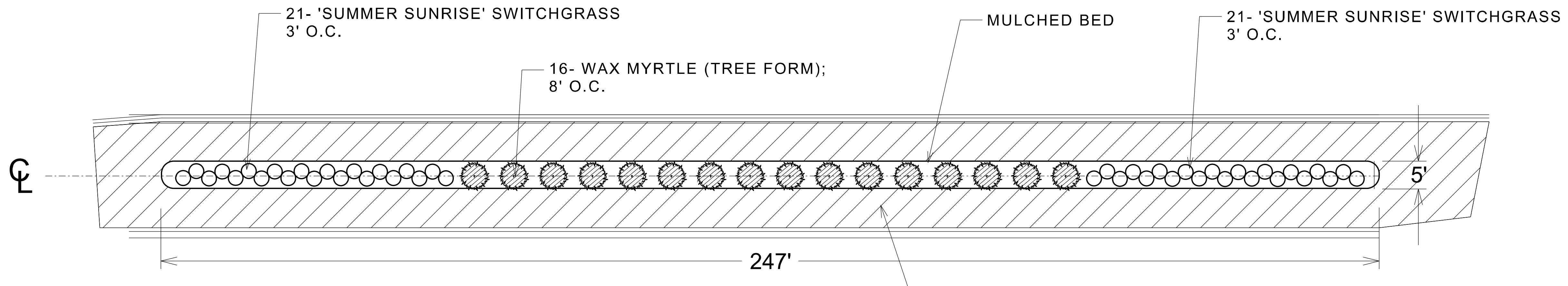

A - PLANT BED DETAIL (MEDIAN)

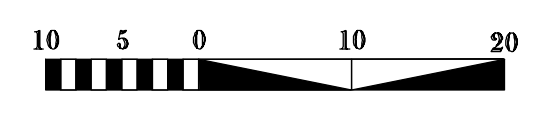

CENTER THE PLANT BED IN THE MEDIAN ISLAND. SURROUNDING TURF SHALL BE TREATED TO ENHANCE CENTIPEDE ESTABLISHMENT (REFER TO SPECIAL PROVISIONS).

CENTER TREES IN THE MEDIAN ISLAND.

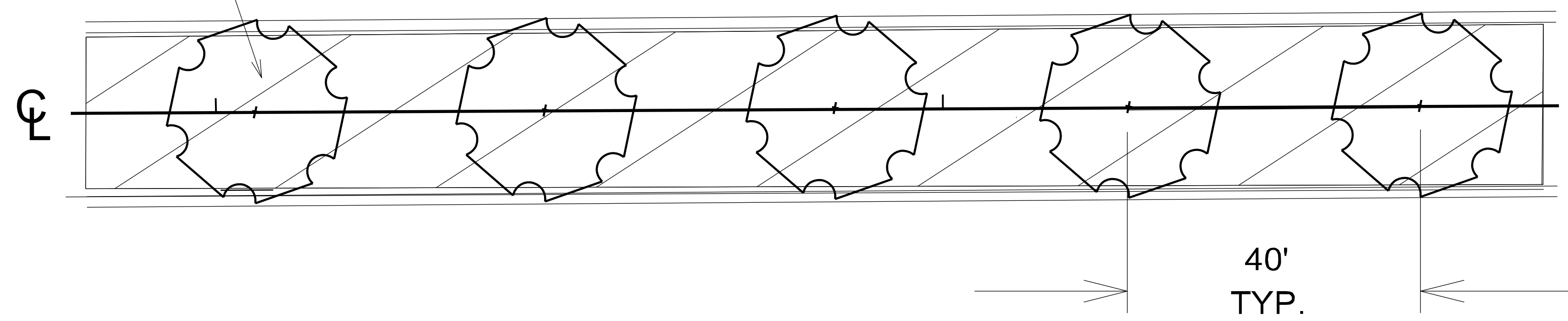

MEDIAN TREE PLANTING

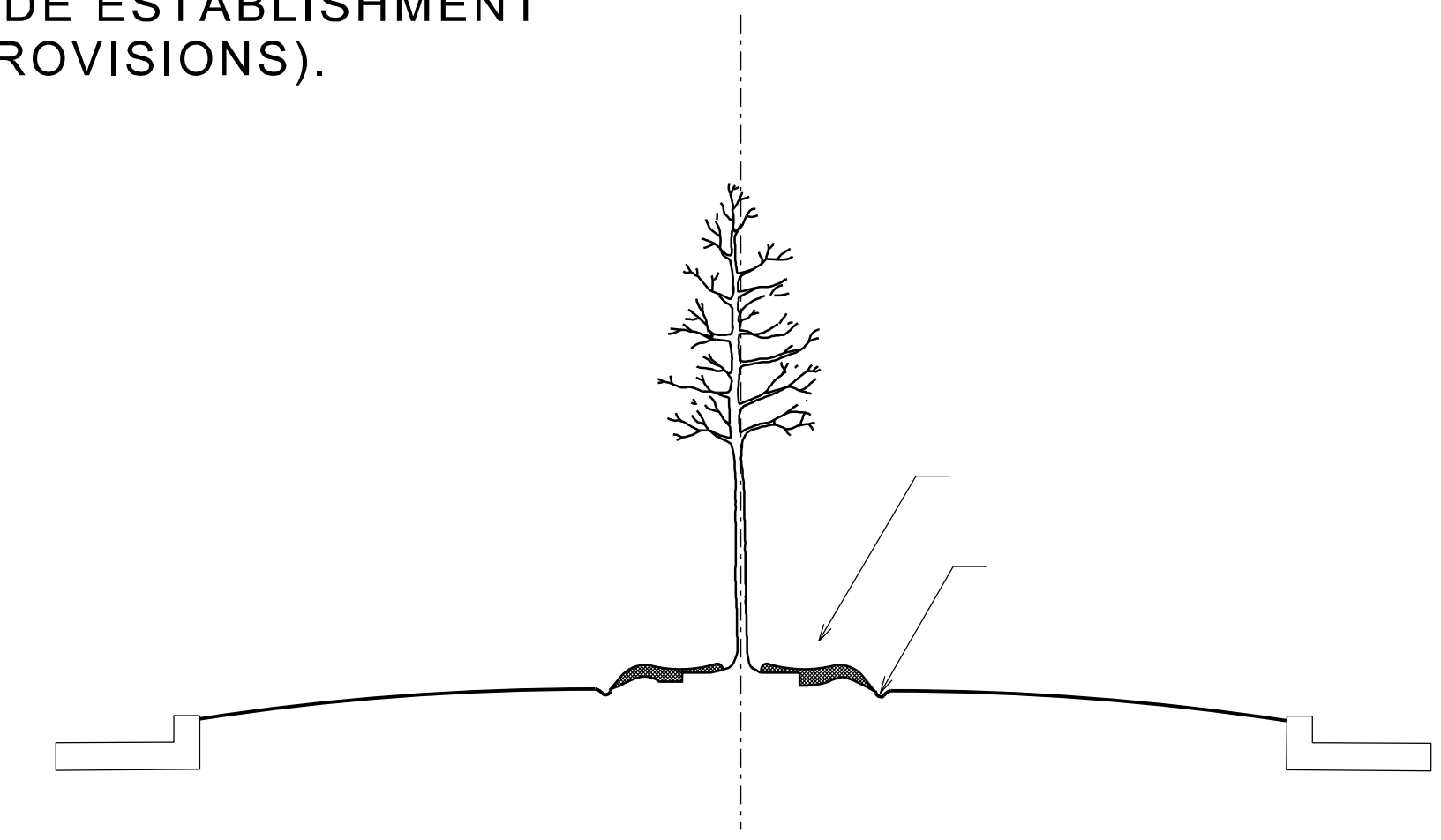
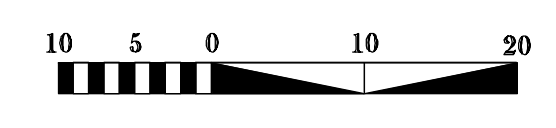

| QUAN. | UNIT | KEY | BOTANICAL NAME | COMMON NAME | DESCRIPTION |
|-------|------|-----|-----------------------------------|----------------------------|------------------------------|
| 12 | EA | | QUERCUS SHUMMARDII | SHUMARD OAK | 10-12', B&B, FULL; 40' O.C. |
| 32 | EA | | MYRICA CERIFERA | WAX MYRTLE | 6-8', B&B, TREE FORM |
| 84 | EA | | PANICUM VIRGATUM 'SUMMER SUNRISE' | SUMMER SUNRISE SWITCHGRASS | #1 CONT. FORM |
| 4300 | SY | | EREMOCHLOA OPHIUROIDES | CENTIPEDE | TURF IMPROVEMENT- SEE SPECS. |
| 40 | CY | | MULCH - DOUBLE SHREDDED HARDWOOD | | |
| 20 | M/G | | WATER FOR PLANTING | | |

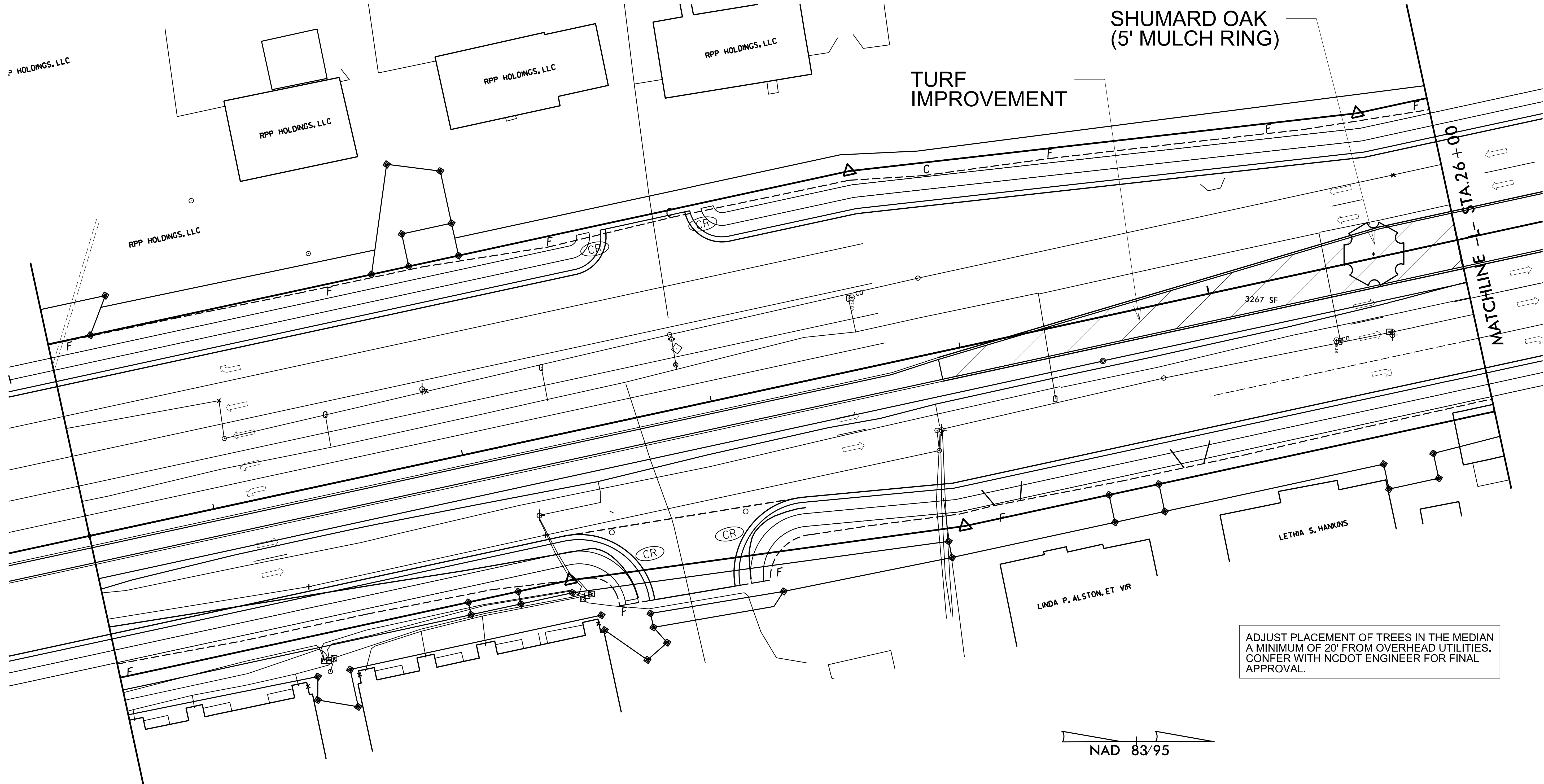

| KEY | BOTANICAL NAME | COMMON NAME | DESCRIPTION |
|-----|-----------------------------------|----------------------------|------------------------------|
| | QUERCUS SHUMMARDII | SHUMARD OAK | 10-12', B&B, FULL; 40' O.C. |
| | MYRICA CERIFERA | WAX MYRTLE | 6-8', B&B, TREE FORM |
| | PANICUM VIRGATUM 'SUMMER SUNRISE' | SUMMER SUNRISE SWITCHGRASS | #1 CONT. FORM |
| | EREMOCHLOA OPHIUROIDES | CENTPEDE | TURF IMPROVEMENT- SEE SPECS. |

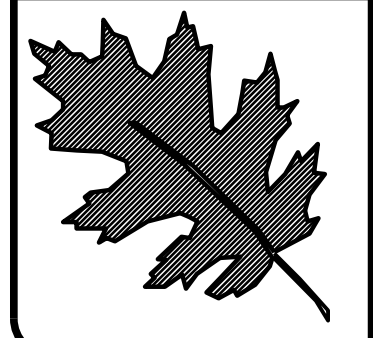
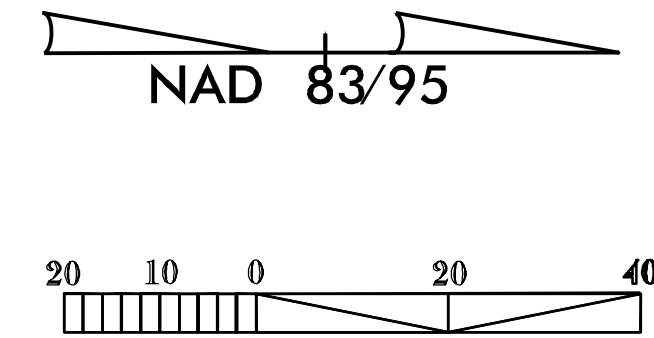

NCDOT - Roadside Environmental Unit
 Aesthetic Engineering Section
 1557 Mail Service Center Raleigh NC 27699-1557
 ph: 919-707-2920 fax: 919-715-2554
<https://www.ncdot.gov/initiatives-policies/environmental/roadside-beautification>

U-3338 B / Kerr Ave.
 Landscape Development Plan
 Wilmington NC

R. Kopetsky

sheet description:
 pref. design date : Aug/2019
 checked by & date :
 final design date : APRIL/2021

Landscape Enhancement
 Plan

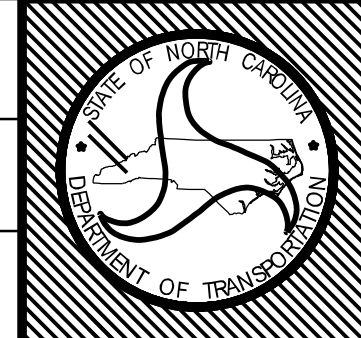

| | |
|-------------|-------------------|
| T.I.P. # | U-3338 B |
| WBS # | |
| FED I.D. # | |
| sheet no. : | total sheet no. : |
| L4 | 10 |

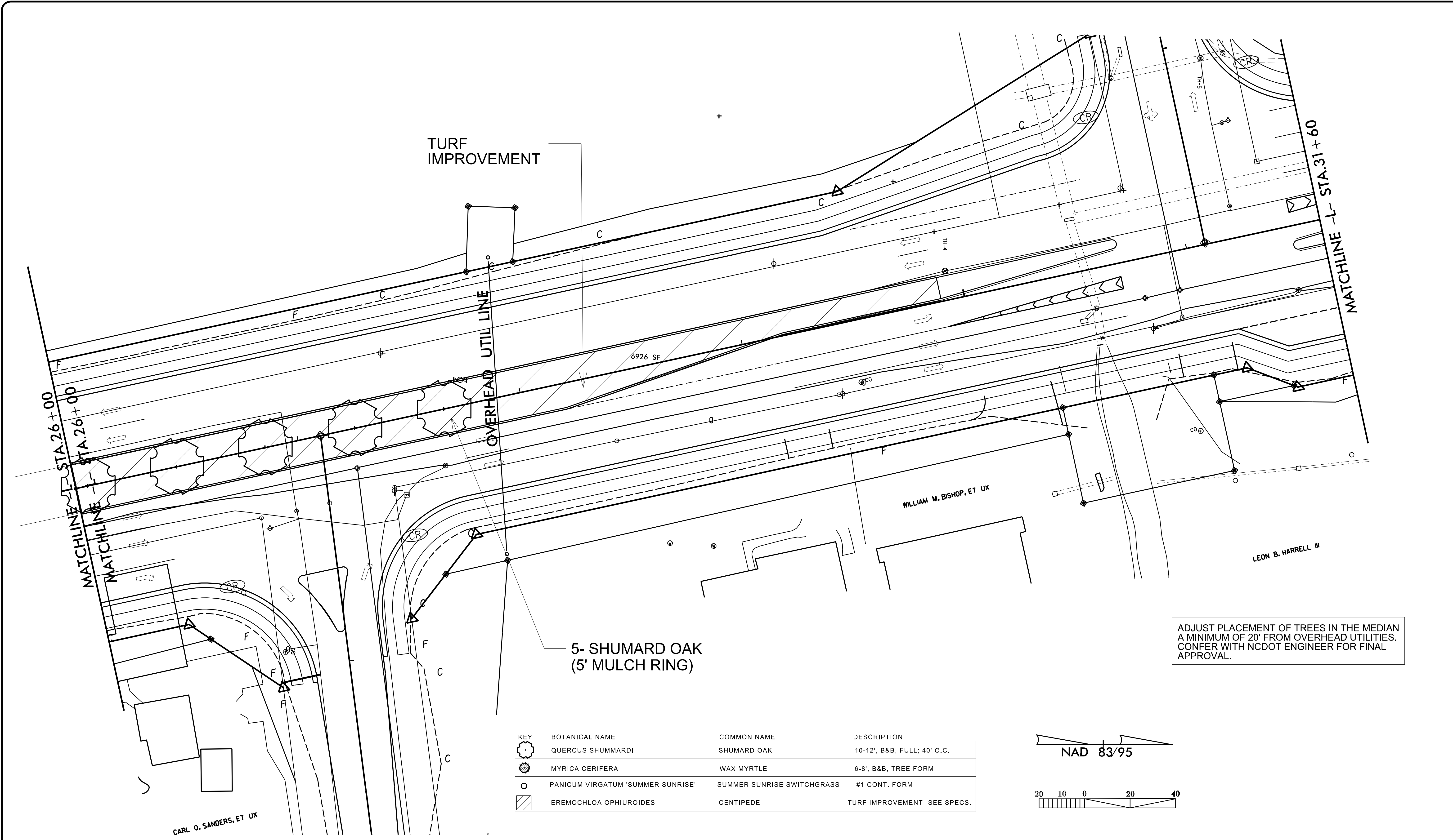

5- SHUMARD OAK
(5' MULCH RING)

ADJUST PLACEMENT OF TREES IN THE MEDIAN
A MINIMUM OF 20' FROM OVERHEAD UTILITIES.
CONFER WITH NCDOT ENGINEER FOR FINAL
APPROVAL.

| KEY | BOTANICAL NAME | COMMON NAME | DESCRIPTION |
|-----|-----------------------------------|----------------------------|------------------------------|
| | QUERCUS SHUMARDII | SHUMARD OAK | 10-12', B&B, FULL; 40' O.C. |
| | MYRICA CERIFERA | WAX MYRTLE | 6-8', B&B, TREE FORM |
| | PANICUM VIRGATUM 'SUMMER SUNRISE' | SUMMER SUNRISE SWITCHGRASS | #1 CONT. FORM |
| | EREMOCHLOA OPHIUROIDES | CENTIPEDE | TURF IMPROVEMENT- SEE SPECS. |

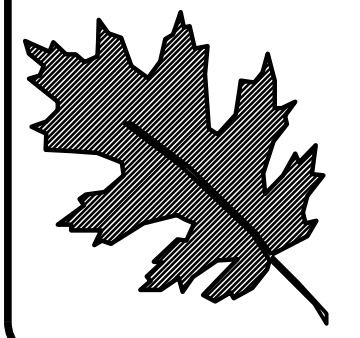
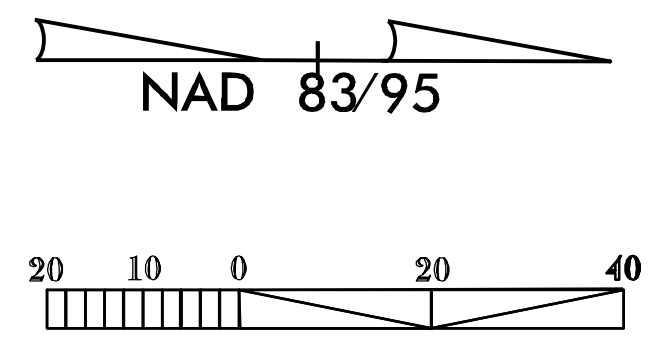

NCDOT - Roadside Environmental Unit
Aesthetic Engineering Section
1557 Mail Service Center Raleigh NC 27699-1557
ph: 919-707-2920 fax: 919-715-2554
<https://www.ncdot.gov/initiatives-policies/environmental/roadside-beautification>

U-3338 B / Kerr Ave.
Landscape Development Plan
Wilmington NC

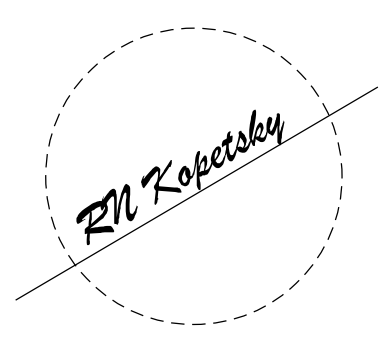

| | |
|--------------------|-----------------------------------|
| sheet description: | prel. design date : Aug/2019 |
| | checked by & date : |
| | final design date : APRIL/2021 |

| |
|-----------------------|
| Landscape Enhancement |
| Plan |

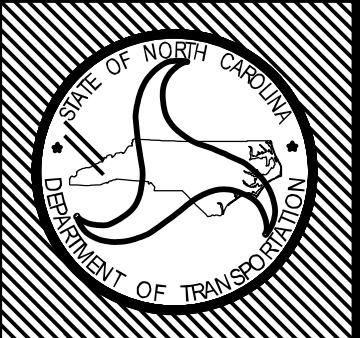

| | |
|------------|------------------|
| T.I.P. # | U-3338 B |
| WBS # | |
| FED I.D. # | |
| sheet no : | total sheet no : |
| L5 | 10 |

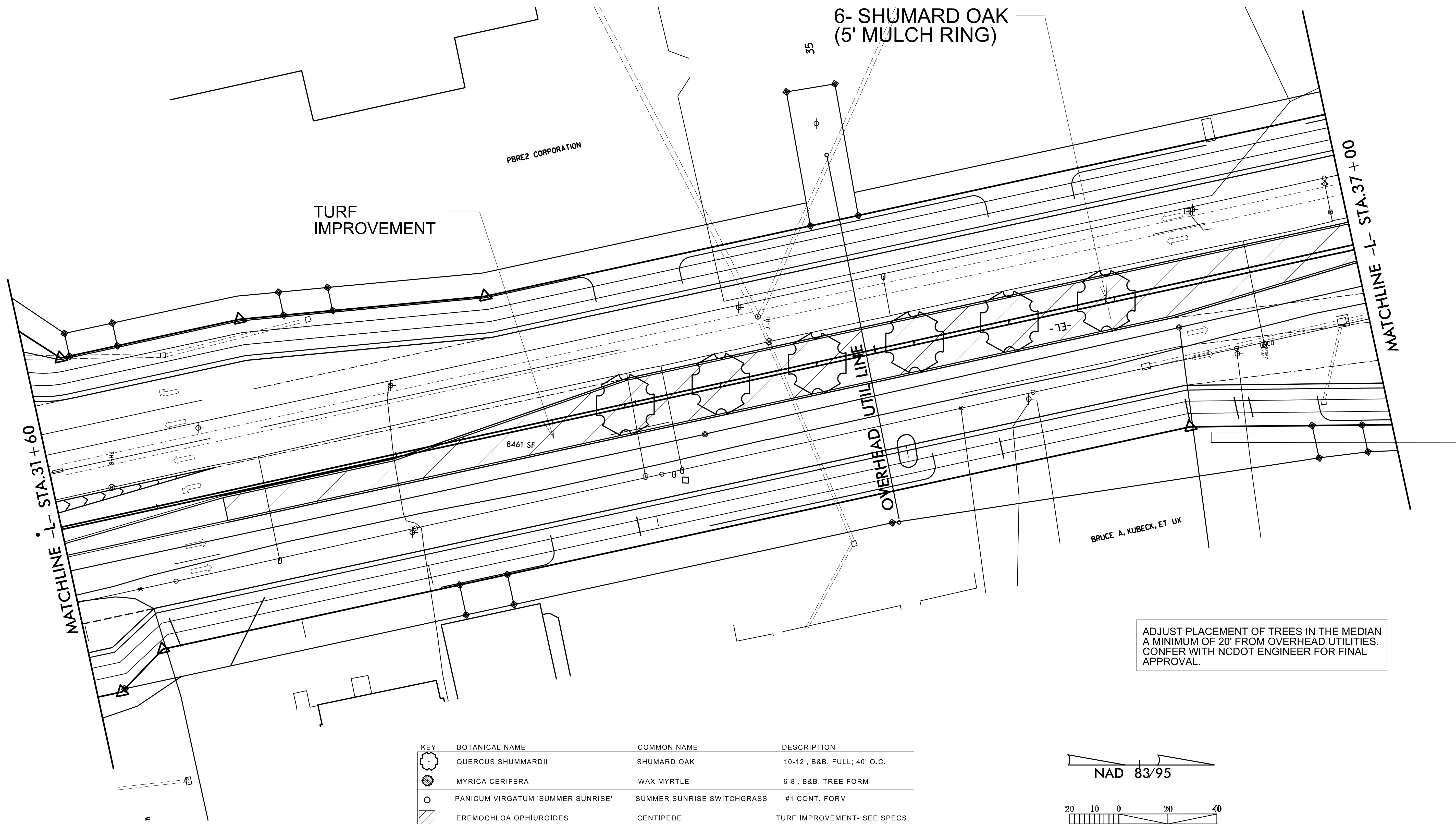

| KEY | BOTANICAL NAME | COMMON NAME | DESCRIPTION |
|-----|-----------------------------------|----------------------------|------------------------------|
| | QUERCUS SHUMMARDII | SHUMARD OAK | 10-12', B&B, FULL; 40' O.C. |
| | MYRICA CERIFERA | WAX MYRTLE | 6-8', B&B, TREE FORM |
| | PANICUM VIRGATUM 'SUMMER SUNRISE' | SUMMER SUNRISE SWITCHGRASS | #1 CONT. FORM |
| | EREMOCHLOA OPHIUROIDES | CENTIPEDE | TURF IMPROVEMENT- SEE SPECS. |

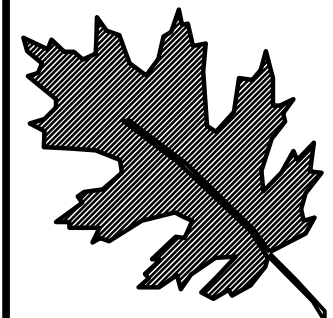
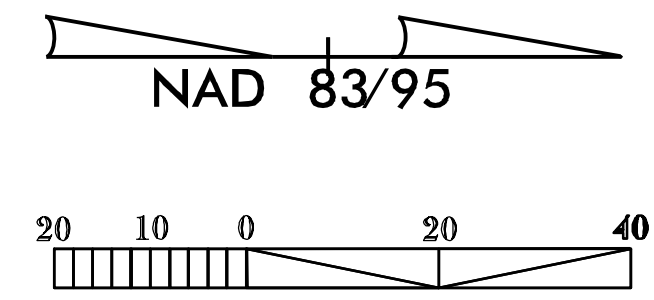

NCDOT - Roadside Environmental Unit
 Aesthetic Engineering Section
 1557 Mail Service Center Raleigh NC 27699-1557
 ph: 919-707-2920 fax: 919-715-2554
<https://www.ncdot.gov/initiatives-policies/environmental/roadside-beautification>

U-3338 B / Kerr Ave.
 Landscape Development Plan
 Wilmington NC

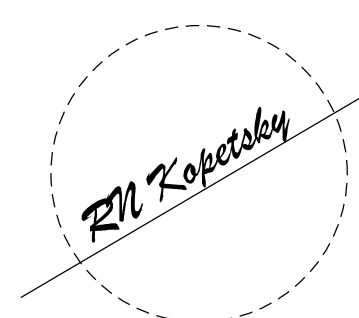

sheet description:
 prel. design date : Aug/2019
 checked by & date :
 final design date : APRIL/21

Landscape Enhancement
 Plan

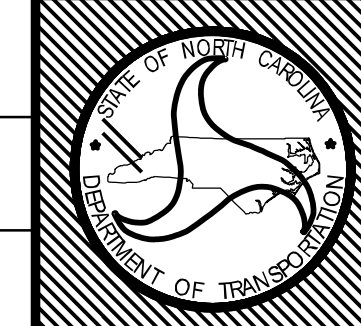

T.I.P. # U-3338 B
 WBS #
 FED I.D. #
 sheet no : L6
 total sheet no : 10

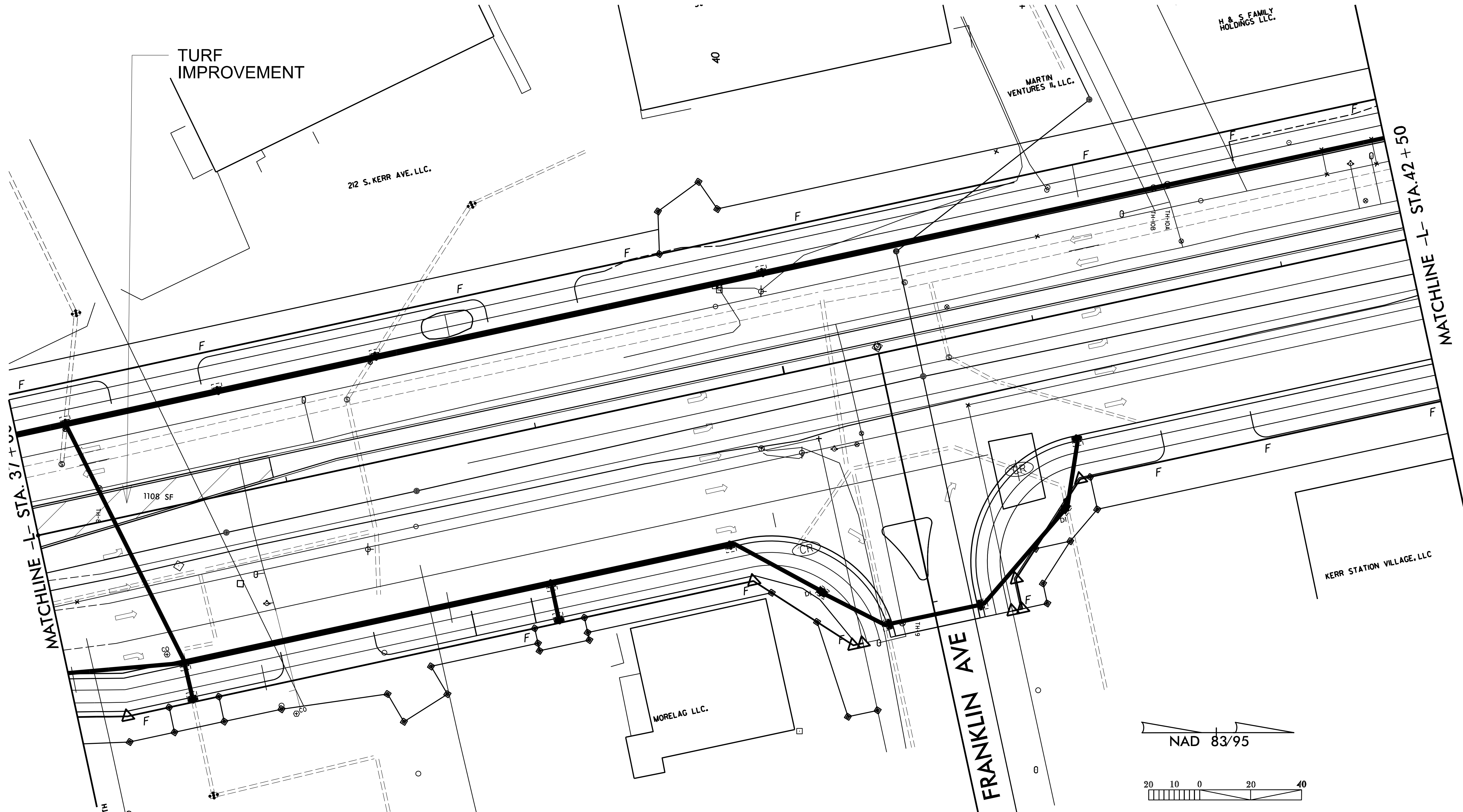

| KEY | BOTANICAL NAME | COMMON NAME | DESCRIPTION |
|-----|-----------------------------------|----------------------------|------------------------------|
| | QUERCUS SHUMARDII | SHUMARD OAK | 10-12', B&B, FULL; 40' O.C. |
| | MYRICA CERIFERA | WAX MYRTLE | 6-8', B&B, TREE FORM |
| | PANICUM VIRGATUM 'SUMMER SUNRISE' | SUMMER SUNRISE SWITCHGRASS | #1 CONT. FORM |
| | EREMOCHLOA OPHIUROIDES | CENTIPEDE | TURF IMPROVEMENT- SEE SPECS. |

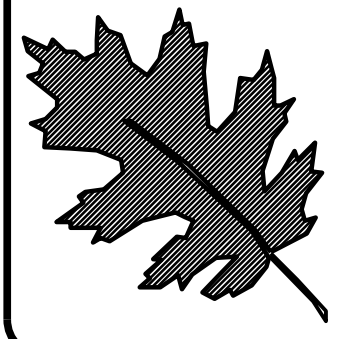
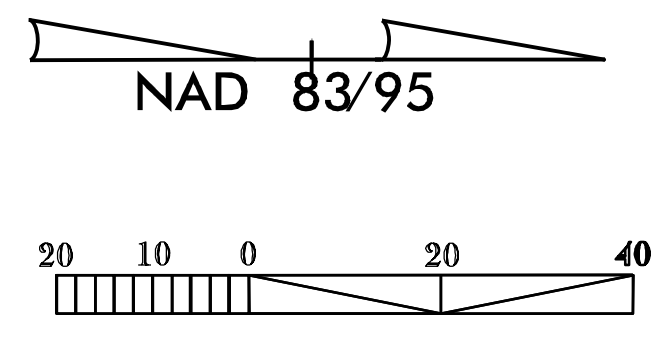

NCDOT - Roadside Environmental Unit
 Aesthetic Engineering Section
 1557 Mail Service Center Raleigh NC 27699-1557
 ph: 919-707-2920 fax: 919-715-2554
<https://www.ncdot.gov/initiatives-policies/environmental/roadside-beautification>

U-3338 B / Kerr Ave.
 Landscape Development Plan
 Wilmington NC

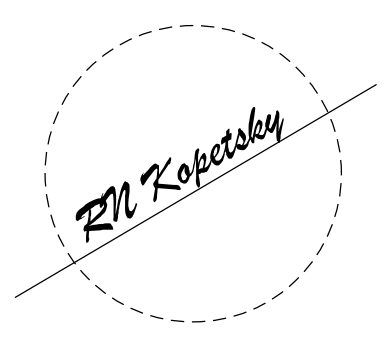

| | | |
|--------------------|---------------------|------------|
| sheet description: | prel. design date : | Aug/2019 |
| | checked by & date : | |
| | final design date : | APRIL/2021 |

Landscape Enhancement
 Plan

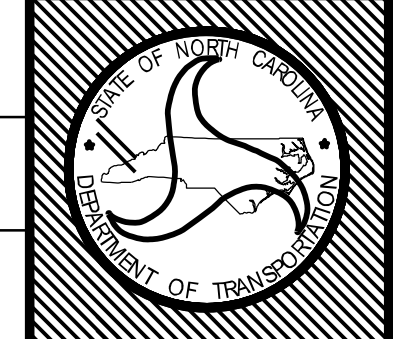

| | |
|------------|------------------|
| T.I.P. # | U-3338 B |
| WBS # | |
| FED I.D. # | |
| sheet no : | total sheet no : |
| L7 | 10 |

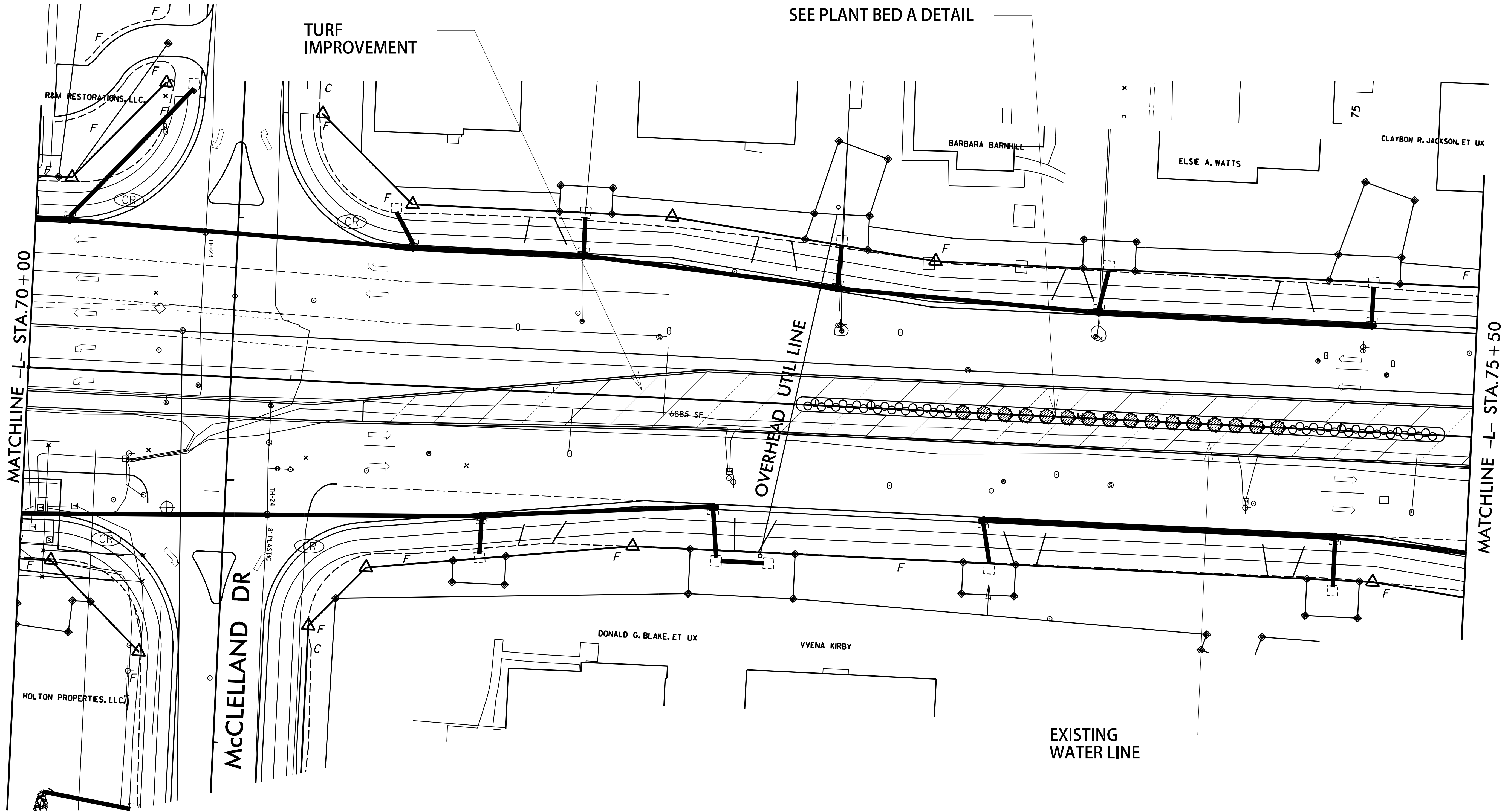

SEE PLANT BED A DETAIL

TURF IMPROVEMENT

MATCHLINE -L- STA. 70 + 00

MATCHLINE -L- STA. 75 + 50

McCLELLAND DR

OVERHEAD UTIL LINE

EXISTING WATER LINE

| KEY | BOTANICAL NAME | COMMON NAME | DESCRIPTION |
|-----|-----------------------------------|----------------------------|------------------------------|
| | QUERCUS SHUMMARDII | SHUMARD OAK | 10-12', B&B, FULL; 40' O.C. |
| | MYRICA CERIFERA | WAX MYRTLE | 6-8', B&B, TREE FORM |
| | PANICUM VIRGATUM 'SUMMER SUNRISE' | SUMMER SUNRISE SWITCHGRASS | #1 CONT. FORM |
| | EREMOCHLOA OPHIUROIDES | CENTIPEDE | TURF IMPROVEMENT- SEE SPECS. |

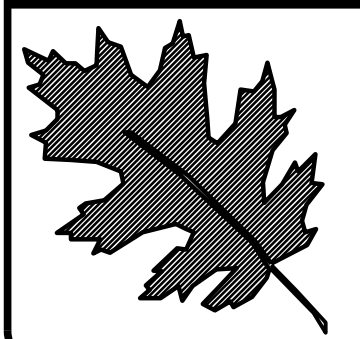
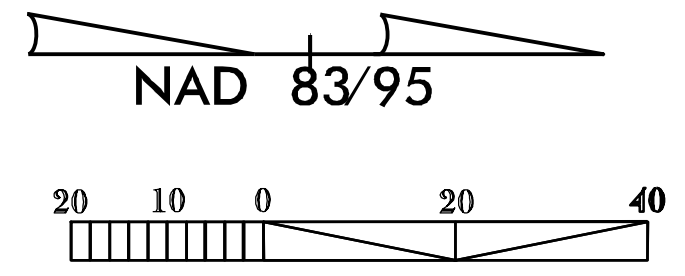

NCDOT - Roadside Environmental Unit
 Aesthetic Engineering Section
 1557 Mail Service Center Raleigh NC 27699-1557
 ph: 919-707-2920 fax: 919-715-2554
<https://www.ncdot.gov/initiatives-policies/environmental/roadside-beautification>

U-3338 B / Kerr Ave.
 Landscape Development Plan
 Wilmington NC

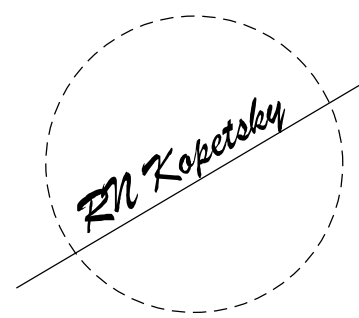

prel. design date : Aug/2019
 checked by & date :
 final design date : APRIL/2021

Landscape Enhancement
 Plan

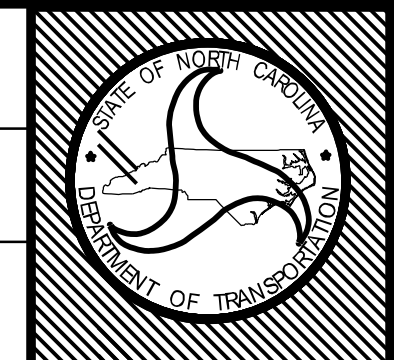

T.I.P. # U-3338 B
 WBS #
 FED I.D. #
 sheet no : L8
 total sheet no : 10

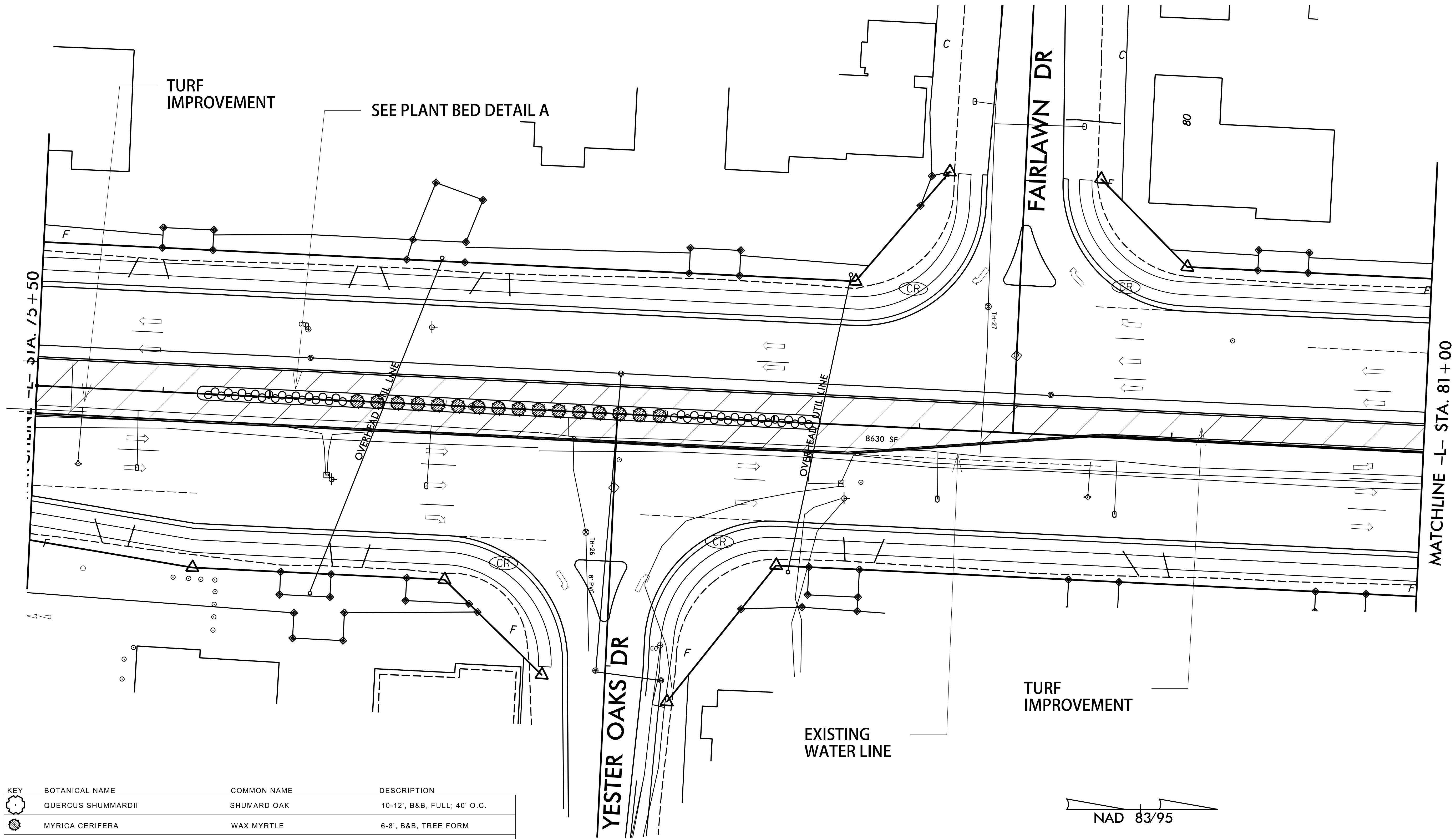

| KEY | BOTANICAL NAME | COMMON NAME | DESCRIPTION |
|-----|-----------------------------------|----------------------------|------------------------------|
| | QUERCUS SHUMARDII | SHUMARD OAK | 10-12', B&B, FULL; 40' O.C. |
| | MYRICA CERIFERA | WAX MYRTLE | 6-8', B&B, TREE FORM |
| | PANICUM VIRGATUM 'SUMMER SUNRISE' | SUMMER SUNRISE SWITCHGRASS | #1 CONT. FORM |
| | EREMOCHLOA OPHIUROIDES | CENTPEDE | TURF IMPROVEMENT- SEE SPECS. |

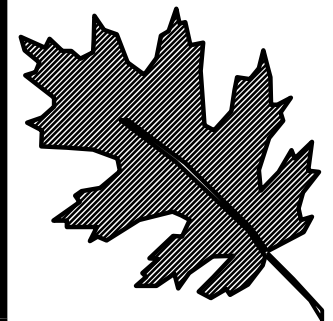
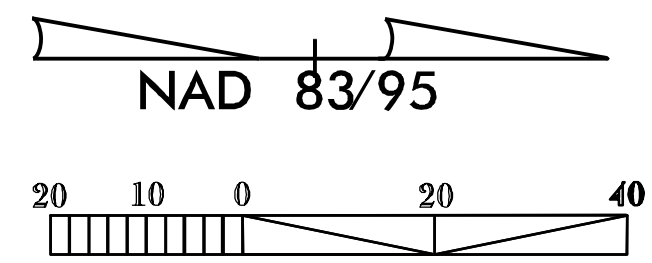

NCDOT - Roadside Environmental Unit
 Aesthetic Engineering Section
 1557 Mail Service Center Raleigh NC 27699-1557
 ph: 919-707-2920 fax: 919-715-2554
<https://www.ncdot.gov/initiatives-policies/environmental/roadside-beautification>

U-3338 B / Kerr Ave.
 Landscape Development Plan
 Wilmington NC

EN Kopetsky

sheet description:
 prel. design date : Aug/2019
 checked by & date :
 final design date : APRIL/2020

Landscape Enhancement
 Plan

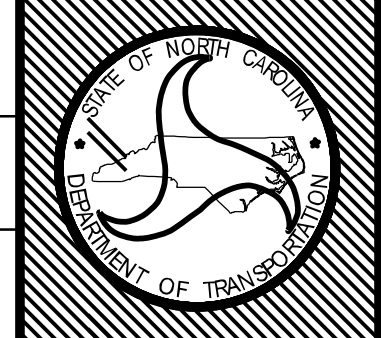

| | |
|------------|------------------|
| T.I.P. # | U-3338 B |
| WBS # | |
| FED I.D. # | |
| sheet no : | total sheet no : |
| L9 | 10 |

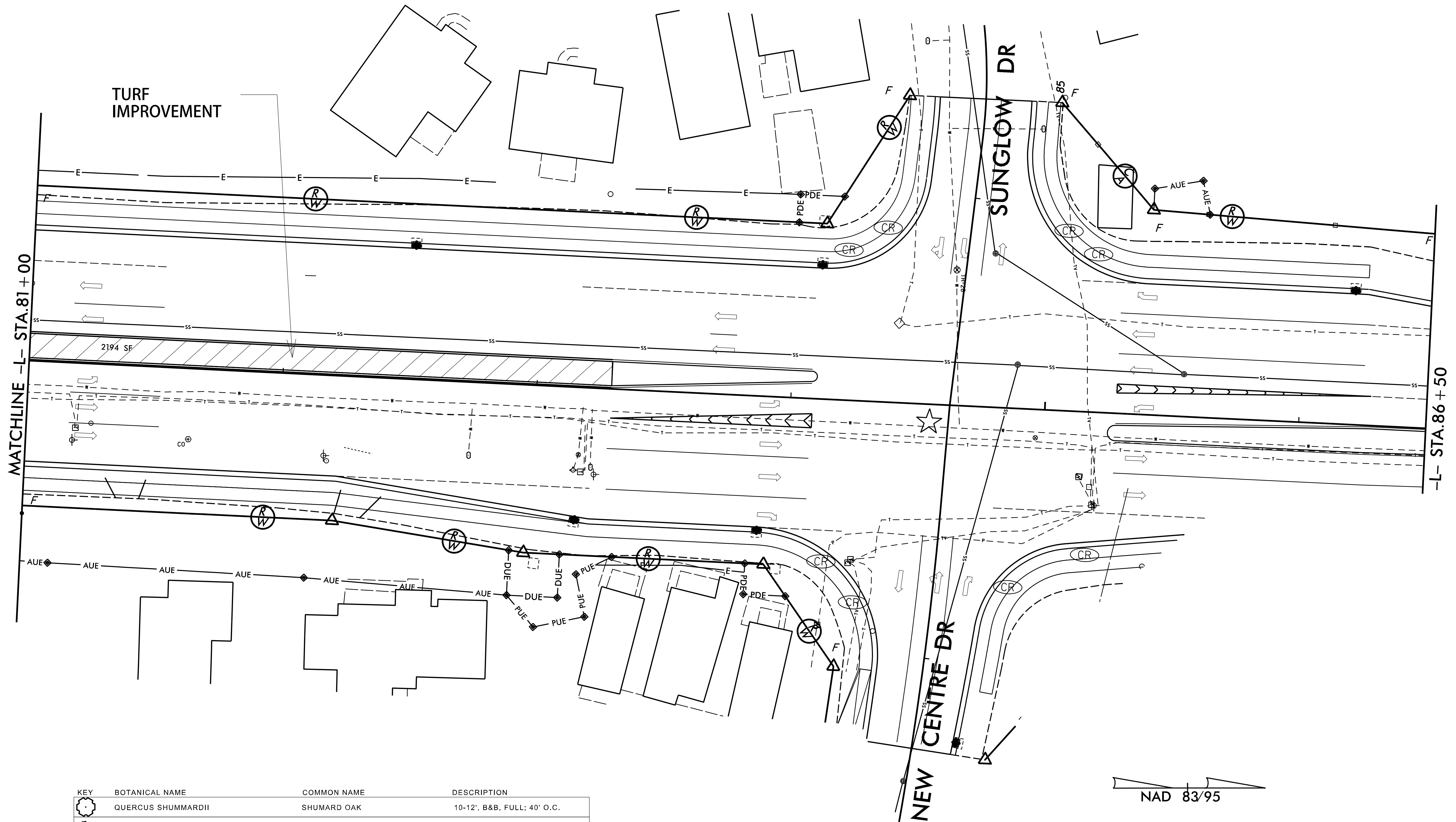

| KEY | BOTANICAL NAME | COMMON NAME | DESCRIPTION |
|-----|-----------------------------------|----------------------------|------------------------------|
| | QUERCUS SHUMARDII | SHUMARD OAK | 10-12', B&B, FULL; 40' O.C. |
| | MYRICA CERIFERA | WAX MYRTLE | 6-8', B&B, TREE FORM |
| | PANICUM VIRGATUM 'SUMMER SUNRISE' | SUMMER SUNRISE SWITCHGRASS | #1 CONT. FORM |
| | EREMOCHLOA OPHIUROIDES | CENTIPEDE | TURF IMPROVEMENT- SEE SPECS. |

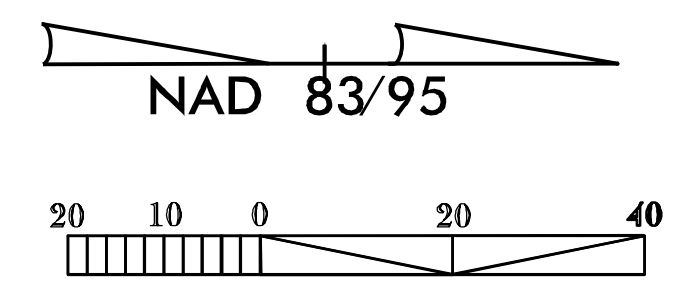

NCDOT - Roadside Environmental Unit
 Aesthetic Engineering Section
 1557 Mail Service Center Raleigh NC 27699-1557
 ph: 919-707-2920 fax: 919-715-2554
<https://www.ncdot.gov/initiatives-policies/environmental/roadside-beautification>

U-3338 B / Kerr Ave.
 Landscape Development Plan
 Wilmington NC

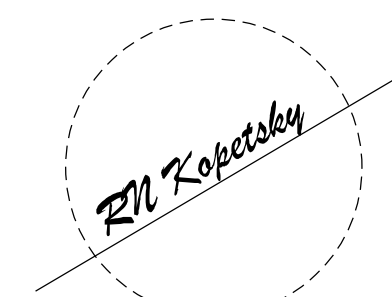

sheet description:
 pref. design date : Aug/2019
 checked by & date :
 final design date : APRIL/2020

Landscape Enhancement
 Plan

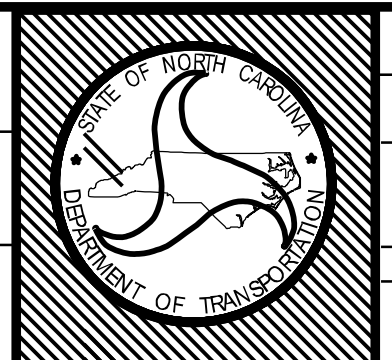

T.I.P. # U-3338 B
 WBS #
 FED.I.D. #
 sheet no : total sheet no :
 L10 10